

Maswell Antenna Mount L shape M12.5 Bracket

401-M12.5-LP

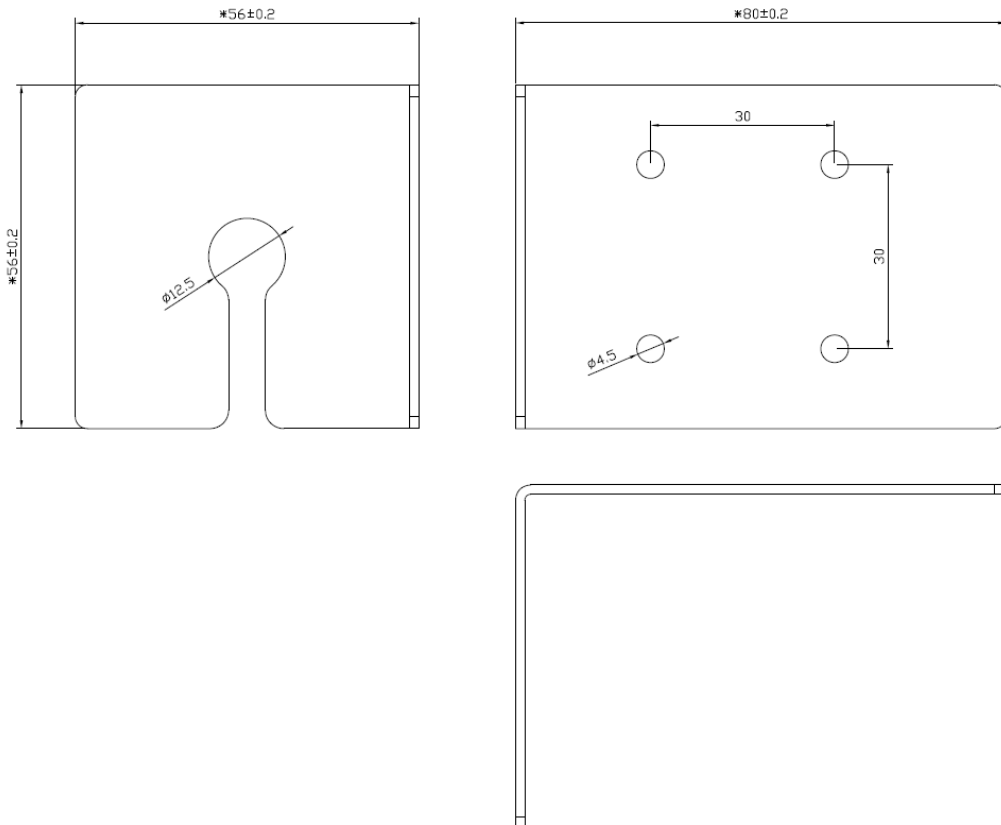

Mechanical Dimension



Maswell Antenna Mount L shape M12.5 Bracket

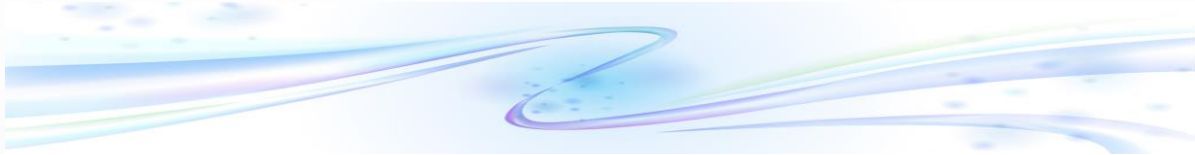

Specifications

Item	Specifications	
L Plate Antenna Mount	Dimension	80mm*56mm*56mm
	Antenna Mounting Hole	M12.5 Suitable for M12.5 M12 M11.5 M11 Antenna bolt
	Plate Installation Hole	4*M4.5
	Material	Stainless Steel