

SPECIFICATIONS

ELECTRICAL

FREQUENCY RANGE _____ 10MHz - 65GHz
 VSWR
 10MHz - 65 GHz _____ <1.60:1 MAX
 INSERTION LOSS
 10MHz - 65GHz _____ 1.25 dB MAX
 AVERAGE POWER _____ 1 WATT
 VOLTAGE _____ 16 VOLTS MAX (INNER ONLY)
 IMPEDANCE _____ 50 OHMS
 OPERATING TEMP RANGE _____ -55°C TO +100°C

MECHANICAL

CENTER CONDUCTOR _____ BERYLLIUM COPPER
 GOLD PLATE IAW MIL-PRF-39012
 HOUSING _____ STAINLESS STEEL PER
 ASTM A484 & A582, CLASS 303, COND. A.
 PASSIVATED PER ASTM A380
 DIELECTRIC _____ TEFLON
 WEIGHT _____ 5g MAX

RoHS COMPLIANT DEVICE

MARKING

PART LOOKS LIKE PRODUCT IMAGE SHOWN.
 PART MARKING ORIENTATION AND FORMAT AS SHOWN.
 MARKING TO BE AS LARGE AS POSSIBLE BE, CLEAR, READABLE.
 YYWW EQUALS DATE CODE

REVISIONS

REV	DESCRIPTION	ECO #	DATE	APPROVED
-	INITIAL RELEASE	18-128	8/27/18	T.KUHN

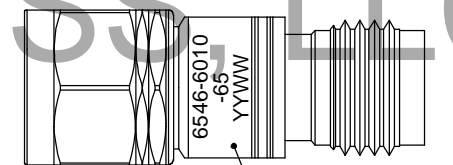
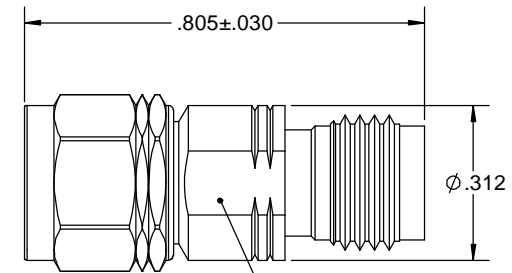
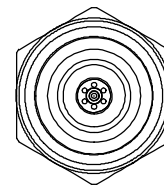

QTY.	PART NUMBER	DESCRIPTION	ITEM NO.
X	6546-6010-65	DC BLOCK, 1.85mm-m/f, 10MHz-65GHz, 16V	
1	TA-6546-6010-65U	ASSEMBLY, DC BLOCK, 1.85mm-m/f, 10MHz-65GHz, 16V, UNMARKED	1

DRAWING PRACTICES PER ANSI-Y-14.5 MIL-STD-100 & 1000	
DIMENSIONS ARE IN INCHES AND APPLY BEFORE / AFTER PROCESSING	
SURFACE ROUGHNESS	63
FINISH:	
SEE NOTE	
MATERIAL:	
SEE NOTE	
NOTE: THIS DRAWING INCORPORATES THIRD ANGLE PROJECTION.	
INTERPRET IAW ANSI Y14.5-1982	

UNLESS OTHERWISE SPECIFIED TOLERANCES IN:		
DECIMALS	INCH	[MM]
.X"	.03"	[.76]
.XX"	.010"	[.25]
.XXX"	.005	[.127]
.XXXX"	.0005"	[.013]
ANGLES ±0°30'		
REMOVE ALL BURRS/SHARP W/ BREAK / R OF .003" TO .0005" UNLESS OTHERWISE NOTED DIAS CONCENTRIC <.003 T.I.R.		
DO NOT SCALE PRINT		

DRAWN	DATE
MCCORMICK	3/5/18
CHECKED	DATE
MCCORMICK	3/5/18
ENG. APPR.	DATE
T.KUHN	3/5/18

Phone: 603-222-2256 Fax: 603-222-2259
 7 Perimeter Road, Manchester, NH 03103

TITLE			
DC BLOCK, 1.85mm-m/f, 10MHz-65GHz, 16V			
SIZE	CAGE CODE	DRAWING NUMBER	REV
B	3HT76	6546-6010-65	-
SCALE	PLATED AREA SQ. IN	SHEET 1 OF 1	

PRECISION WIRELESS, LLC